

Assembly Using Wood Fuel

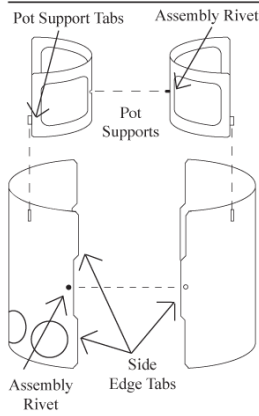

Assembly Using Alcohol Fuel

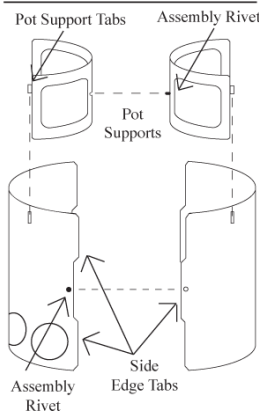

Important!

Pot support tabs are down for wood and up for alcohol.

Step 1

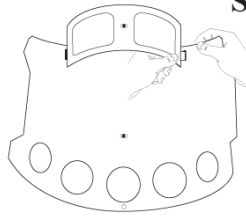

Attach pot supports to the upper closed slots in the stove sides. **Most of the pot support will be above the top of the stove side.**

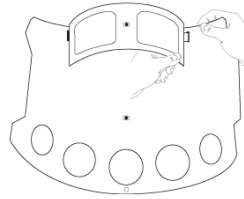

Attach pot supports to the upper closed slots in the stove sides. **Most of the pot support will be below the top of the stove side.**

Step 2

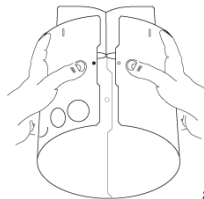

All three side edge tabs go inside the stove. Make sure all three assembly rivets enter their holes.

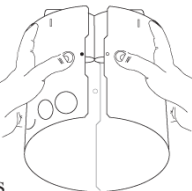

Stove Assembled

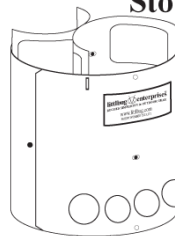

Place stove over your alcohol burner (not included).

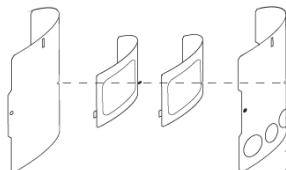
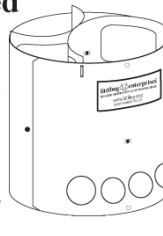

Pieces Nest for Transport

littlbug enterprises™
RUGGED SIMPLICITY in OUTDOOR GEAR

Revised 2-2-10

Suggestions for getting the most out of your Littlbug Stove can be found at www.littlbug.com. Click the **Camping Hints** button on the left side of the page.